

Ferrule Fuse Links

FWP

**690/700V (IEC/UL):
5-50A (14 x 51mm)**

Specifications

Description: Ferrule style high speed fuse links for the protection of DC common bus, DC drives, power converters/rectifiers and reduced voltage starters. Low watts loss in a compact size and used with finger-safe holders/blocks. Available with or without striker for remote indication.



Ratings:

- Volts:— 690Vac (IEC) / 700Vac (UL)
- Amps:— 1-50A (14x51)
- IR:— 200kA RMS Sym.
- 50kA @ 700Vdc

Operating Class: aR

Agency Information: CE, UL Recognition, CSA Component Acceptance for versions without striker only.

Dimensions - mm (in):

14 x 51 - Without Striker

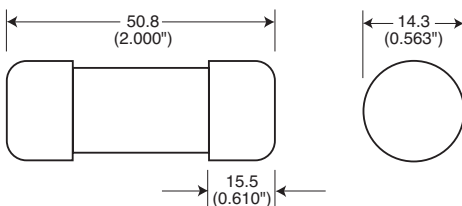

14 x 51 - With Striker

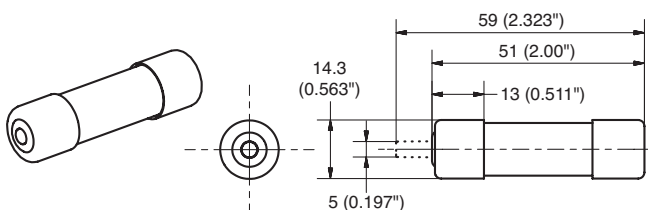

Catalogue Numbers	Fuse Size	Rated Current RMS-Amps	Electrical Characteristics		Watts Loss
			I ² t (A ² Sec)		
			Minimum Melting	Clearing At Rated Voltage	
Without Striker	14 x 51mm (⁹ / ₁₆ " x 2")	1	0.035	0.41	5.7
FWP-1A14F		2	0.08	0.11	8.7
FWP-2A14F		2.5	—	—	—
FWP-3A14F		3	0.11	0.26	2.8
FWP-4A14F		4	0.1	0.23	3.0
FWP-5A14F		5	1.6	11.0	1.5
FWP-10A14F		10	3.6	38.5	4
FWP-15A14F		15	8.6	70	5.5
FWP-20A14F		20	26.0	230	6
FWP-25A14F		25	46.5	375	7
FWP-30A14F		30	58	485	9
FWP-32A14F		32	68	600	7.6
FWP-40A14F		40	84	750	8
FWP-50A14F		50	200	1800	9
With Striker	14 x 51mm (⁹ / ₁₆ " x 2")	10	3.6	38.5	4
FWP-10A14FI		15	8.6	70	5.5
FWP-15A14FI		20	26.0	230	6
FWP-20A14FI		25	46.5	375	7
FWP-25A14FI		30	58	485	9
FWP-32A14FI		32	68	600	7.6
FWP-40A14FI		40	84	750	8
FWP-50A14FI	50	200	1800	9	

Data Sheets: E5781724, 720025

Ferrule Fuse Links

FWP

690/700V (IEC/UL): 20-100A (22 x 58mm)

Specifications

Description: Ferrule style high speed fuse links for the protection of DC common bus, DC drives, power converters/rectifiers and reduced voltage starters. Low watts loss in a compact size and used with finger-safe holders/blocks. Available with or without striker for remote indication.



Ratings:

Volts:— 690Vac (IEC) / 700Vac (UL)

Amps:— 20-100(22x58)

IR:— 200kA RMS Sym.
— 50kA @ 700Vdc

Operating Class: aR

Agency Information: CE, UL Recognition, CSA Component Acceptance for versions without striker only.

22 x 58 - Without Striker

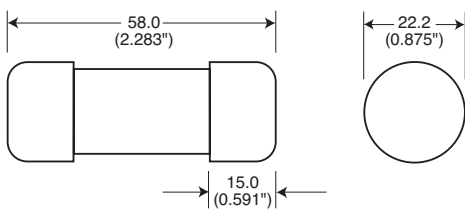

22 x 58 - With Striker

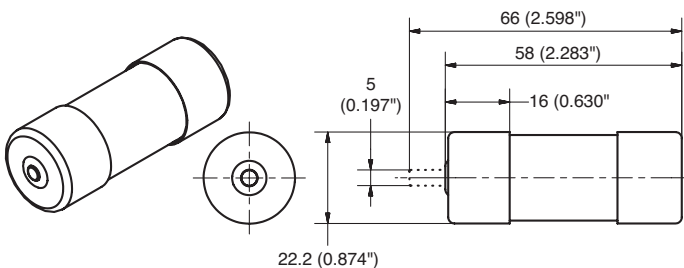

Catalogue Numbers	Fuse Size	Rated Current RMS-Amps	Electrical Characteristics		
			Minimum Melting	Clearing At Rated Voltage	Watts Loss
Without Striker	22 x 58mm (7/8" x 2 9/32")				
FWP-20A22F		20	19.0	260	5
FWP-25A22F		25	34.0	410	6
FWP-32A22F		32	53.5	605	8
FWP-40A22F		40	68	750	9
FWP-50A22F		50	135	1600	9.5
FWP-63A22F		63	280	3080	11
FWP-80A22F		80	600	6600	13.5
FWP-100A22F		100*	1100	12500	16
With Striker					
FWP-20A22FI	22 x 58mm (7/8" x 2 9/32")	20	19.0	260	5
FWP-25A22FI		25	34.0	410	6
FWP-32A22FI		32	53.5	605	8
FWP-40A22FI		40	68	750	9
FWP-50A22FI		50	135	1600	9.5
FWP-63A22FI		63	280	3080	11
FWP-80A22FI		80	600	6600	13.5
FWP-100A22FI		100*	1100	12500	16

*IEC/UL Voltage rating 600/700

Data Sheets: E5781723, 720026